



320A BATTERY VEHICLE PLUGS, TYPE FEM, IP23 - NEOPRENE RUBBER

This connector is used extensively in mines on surface and underground, it is virtually indestructible due to its neoprene rubber housing.

HIGH QUALITY STANDARD CONNECTOR
FOR CHARGING AND POWERING
ELECTRIC VEHICLES

Rated at 320A 150V DC

This DC connector has been designed to comply with various European standards, amongst other FEM Section 4.



Special Features

- Codeable for 24/36/43/72/80/96V - once coded they cannot be interchanged with other voltages
- Absolutely safe even under full load of 320A (VDE-Finger Acc. to VDE 0470 3)
- 2 20A pilot contacts with late make/early break feature (optional)
- Connector very compact
- Connector virtually unbreakable
- Flame resistant

AMPS	MALE PLUG	FEMALE PLUG	HANDLE*	FEMALE AUX	MALE AUX
320	A2026	A2025	Included on male plug	A2014	A2036

*Handle can be removed and fitted to female plug if necessary.

Technical Data:

Style:	320A
Number of contacts:	2 main contacts ø 10mm (+/-) 2 aux. contacts [†] ø 4mm
Rated current:	320A/20A
Rated voltage:	150V max.
Polarised voltages indicator:	24/36/48/72/80/96 V
Temperature range:	-25° to 90°C
Wire section:	50/70/95 mm ²
Contacts:	Male live - copper, silver plated Female live - copper, silver plated Aux. pins - brass, nickel plated
Terminations:	Solder
Protective system:	IP23
Shell material:	Neoprene rubber

Dimensions (mated connector)

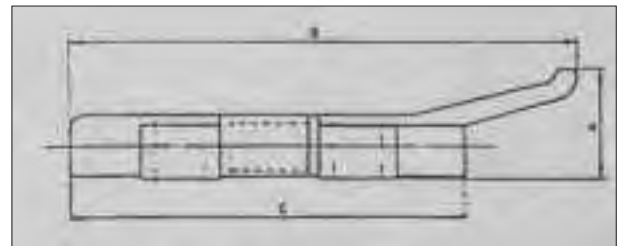

Style	A approx.	B approx.	C approx.
320A	75mm	310mm	290mm

[†]If pilot function is desired as an optional extra (for example for contactor control, etc.)